

# Centro Door

## Assembly Instructions



1



Take first 'L' shaped connector bar and with the wider part lowermost, slide narrower upright to bottom of the Centro post in channel you wish the door to be positioned. Repeat for the second 'L' shaped connector in the corresponding channel of opposite post.

2



Carefully place door threshold onto base plates between posts. Insert wide section of first 'L' shaped connector into end of door threshold and tighten grub screws to secure. Repeat process for opposite post.

3



Assemble two of the 950mm straight profiles by inserting half of connector bar into one end of profile, tighten 2 grub screws, and assemble upper 950mm straight profile. Repeat process for other two 950mm straight profiles.

4



Affix middle horizontal 654mm profile (with handle on front), halfway between verticals of door. The profile is affixed by tightening grub screws so expanding clamp is secured into channel of profiles. Ensure lock lever is located on the outside of the door assembly.

5

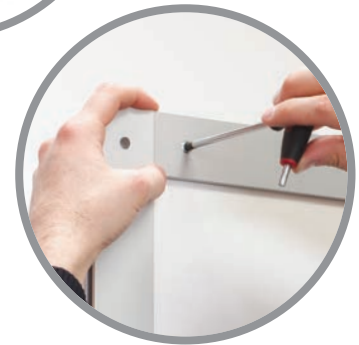

Slide upper and lower rigid panels into channels of profiles (as shown right). Secure panels in position by assembling top and bottom horizontal 654mm straight profiles (as shown above right).

6



Slide one side of first hinge with connector bar into same channel of post in which the door threshold is secured. Slide second hinge into channel of vertical profile, on opposite side to lock and handle, until it rests on connector bar in the door. Tighten two screws to secure hinge to door frame.

7



Raise door assembly and slide connector bar of second hinge into same channel of post as first hinge. Position bottom of door frame over first hinge and rest assembly on door threshold. Tighten two screws in frame to secure.

8



Raise door so there is an approximate 25mm (1 inch) gap between underside of door frame and top of door threshold. Tighten screws of hinges in post channel to secure.

9



Slide third/final hinge with connector bars into same channel of post and door vertical profile. Position hinge near top of door and tighten four screws to secure. Finish door assembly by positioning straight 750mm profile flush with the top of the posts, and tighten grub screws to secure.

10

Final assembled door should look similar to image shown right.

