

# ST2 85 Roll Up Assembly Instructions

1



Remove your roll up from it's carry bag, stored in the underside of the cassette are the bungee poles.

2

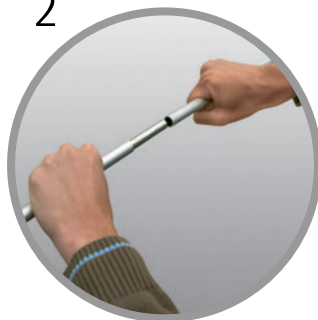

Take the poles and allow all three sections to slide together.

3



Insert the poles into the cassette, ensuring that it is fully located.

4



Pull the first top rail straight upwards ensuring not to damage the graphic.

5

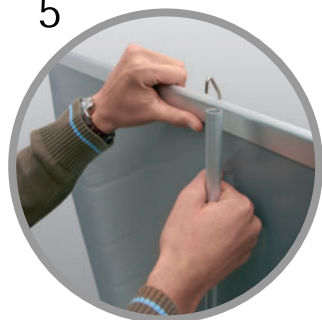

Hook the top rail onto the top of the pole.

6



Pull the second top rail straight upwards ensuring not to damage the graphic and repeat as before.

