

# START3 Assembly Instructions

1

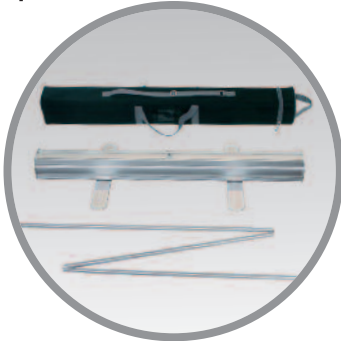

Remove your roll up and bungee pole from the carry bag.

2

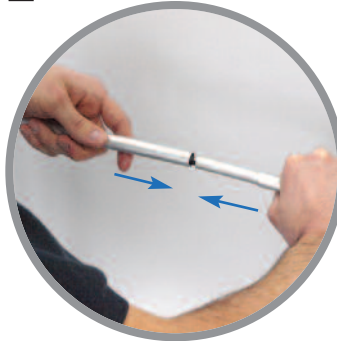

Take the bungee pole and allow all three sections to slide together.

3

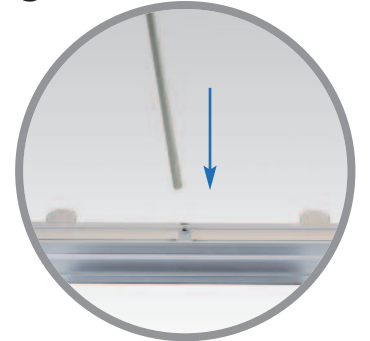

Insert the pole into the cassette, ensuring it is fully located.

4



Firmly hold and pull graphic rail upwards, ensuring not to damage the graphic.

5



Slide the graphic rail moulding over the top of the bungee pole.

